

Lubrication System

LUBSEAL[®]

DIN69051 ISO3408 Standard Ball Screws

DZ / FZ / GT



Lubrication System LUBSEAL®

Clean and gently for the environment and effecting your machines.

Prolonged maintenance free period.

At least 20.000km running availability during the machine operating.

Just fit and no-protruding seal system from ball screw nut.

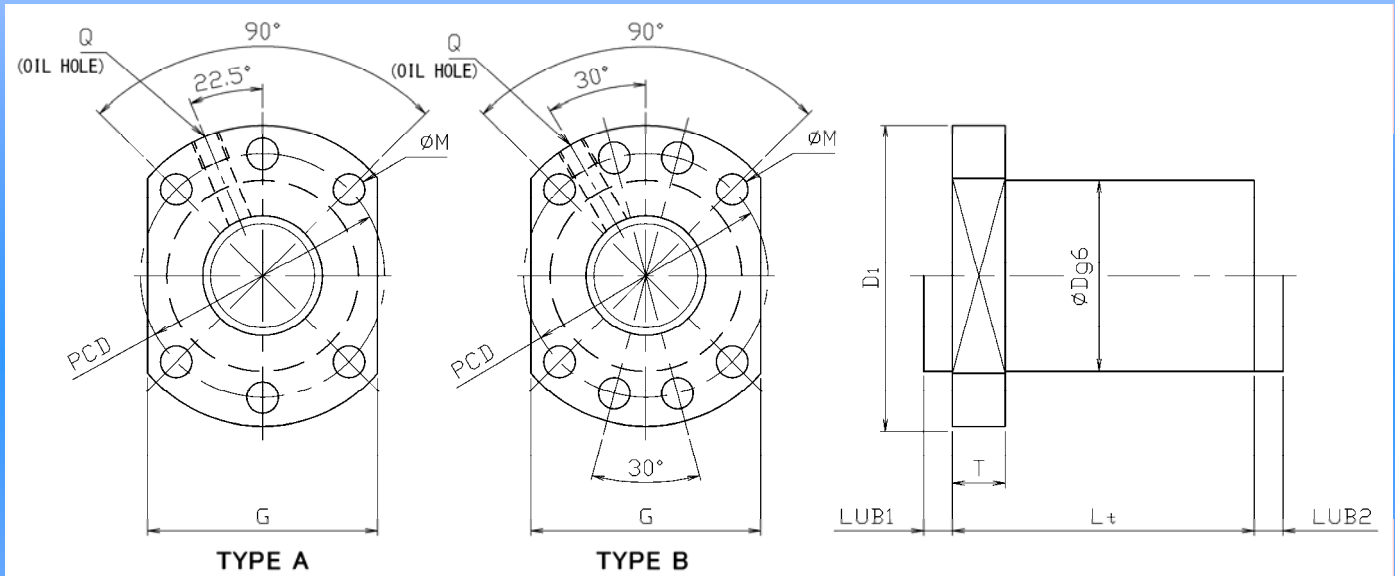
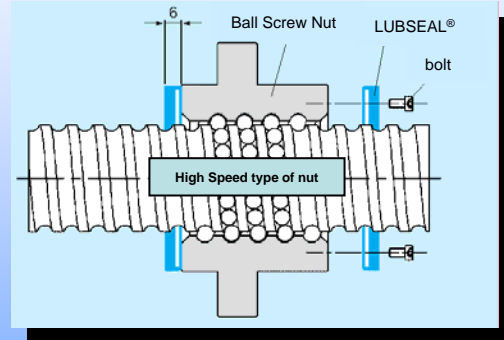
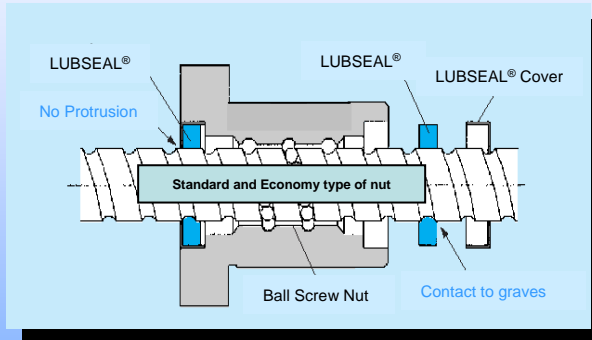

Model No.	Nominal Diameter	Lead	Ball Screw Type*	Lead Accuracy	Axial Play 0mm	Number of Circuits	Basic Load Ratings		Nut Dimensions										
	d	L					Dynamic C_a [N]	Static C_{0a} [N]	D	D ₁	TYPE	L ₁	T	LUB1*	LUB2	G	PCD	M	Q
DZ1605JS-ZDSR	16	5	S	C0 - C10	○	3 x 1	7,700	14,600	28	48	A	55	12	0	6	40	38	5.5	M6X1
DZ2005JS-ZDSR	20	5	S	C0 - C10	○	3 x 1	8,900	18,900	36	58	A	54	13	0	6	44	47	6.6	M6X1
DZ2005KS-ZDSR		5	S	C0 - C10	○	4 x 1	11,400	25,200		58	A	59	13	0	6	44	47	6.6	M6X1
GT2005JS-ZDSR	20	5	E	C7 - C10	x	3 x 1	6,600	15,900	36	58	A	54	13	0	6	44	47	6.6	M6X1
GT2005KS-ZDSR		5	E	C7 - C10	x	4 x 1	8,800	21,200		58	A	59	13	0	6	44	47	6.6	M6X1
DZ2010JS-ZDSR	25	10	S	C0 - C10	○	3.7 x 1	10,000	19,000	40	58	A	71	13	0	6	44	47	6.6	M6X1
DZ2505JS-ZDSR		5	S	C0 - C10	○	3 x 1	9,800	23,400		62	A	56	15	0	6	48	51	6.6	M6X1
GT2505JS-ZDSR	25	5	E	C7 - C10	x	3 x 1	7,300	19,700	40	62	A	56	15	0	6	48	51	6.6	M6X1
FZ2505PS-ZPSR		5	H	C0 - C10	○	3 x 1	13,100	31,800		62	A	42	12	6	6	48	51	6.6	M6X1
DZ2510JS-ZDSR	25	10	S	C0 - C10	○	3 x 1	12,000	25,800	40	62	A	73	15	0	6	48	51	6.6	M6X1
FZ2525PS-ZPSR		25	H	C0 - C10	○	ASK	ASK	ASK		62	A	ASK	15	6	6	48	51	6.6	M6X1
DZ3205JS-ZDSR	32	5	S	C0 - C10	○	3 x 1	11,300	31,100	50	80	A	56	15	0	6	62	65	9	M8X1
DZ3205KS-ZDSR		5	S	C0 - C10	○	4 x 1	14,500	41,500		80	A	61	15	0	6	62	65	9	M8X1
DZ3210JS-ZDSR	32	10	S	C0 - C10	○	3 x 1	26,900	58,400	50	80	A	84	15	0	6	62	65	9	M8X1
DZ4010JS-ZDSR		10	S	C0 - C10	○	3 x 1	31,300	80,300		93	B	89	18	0	6	70	78	9	M8X1
DZ4010KS-ZDSR	40	10	S	C0 - C10	○	4 x 1	40,100	100,000	63	93	B	99	18	0	6	70	78	9	M8X1
DZ5010JS-ZDSR		10	S	C0 - C10	○	3 x 1	35,700	98,100		110	B	89	18	0	6	85	93	11	M8X1
DZ5010KS-ZDSR	50	10	S	C0 - C10	○	4 x 1	45,700	130,000	75	110	B	99	18	0	6	85	93	11	M8X1
DZ5010KS-ZDSR		10	S	C0 - C10	○	4 x 1	45,700	130,000		110	B	99	18	0	6	85	93	11	M8X1

*Ball Screw Type S: Standard E: Economy H: High Speed

*LUB1 0mm means there is a LUBSEAL® inside of the flange.

KURODA PRECISION INDUSTRIES LTD.

239 Shimohirama, Saiwai, Kawasaki, 212-8560, Japan
 TEL +81-44-555-3805 FAX +81-44-555-1479
<http://www.kuroda-precision.com>
ovs_dpt@kuroda-precision.co.jp

ROTRA

Antriebsentwicklung GmbH
 Daniel-Müller-Str. 39
 64347 Griesheim, Germany
 Tel: +49-(0)6155-61306
info@rotra-tech.de
www.rotra-tech.de